

# INSTALLATION INSTRUCTIONS

**EN**

L mount Bracket

**RLS-LBL**
**REDSCAN Lite**
**OPTION**

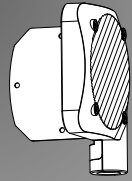



Web reference

<https://navi.optex.net/manual/50552>

## 1 Before installation

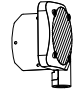

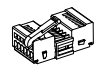
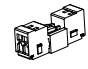
- Use exclusively with the REDSCAN Lite: RLS-1010L.

①		x 1	L mount Bracket	②		x 4	Screws
③		x 1	Connector 6 pairs (Signals)	④		x 1	Connector 2 pairs (Power)

## 2 Parts Identification

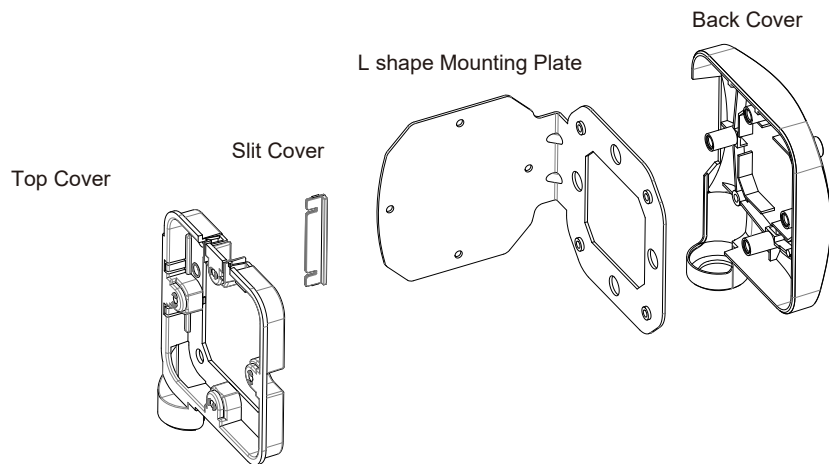

## 3 Dimension

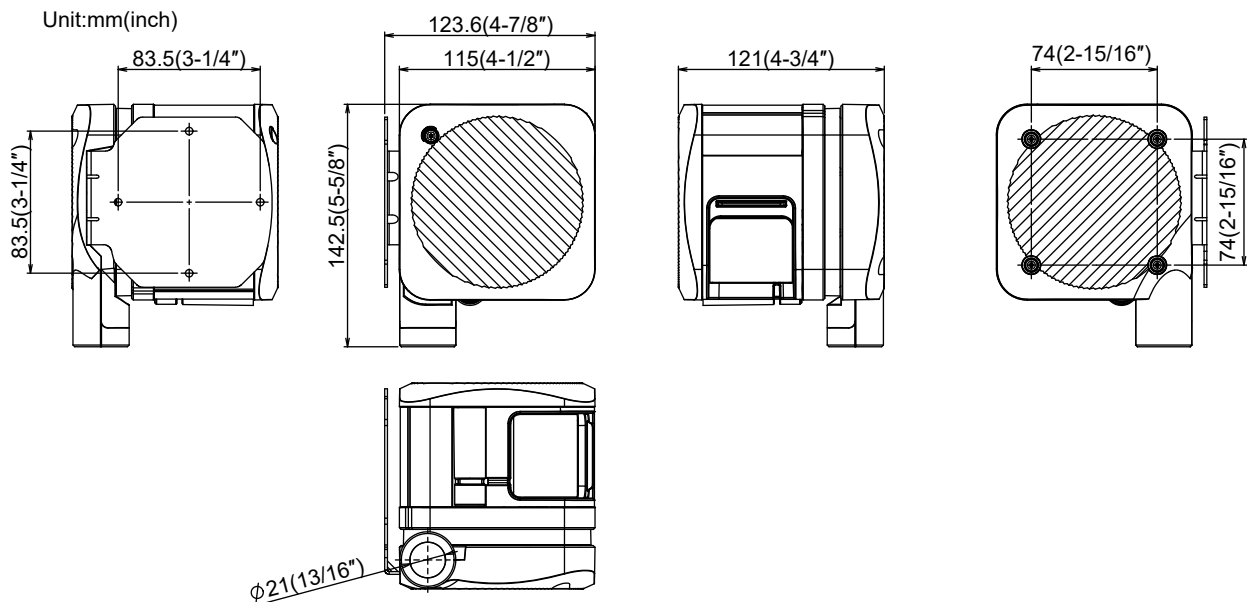

### EU contact information

<https://navi.optex.net/cert/contact/>

OPTEX INC./AMERICAS HQ (U.S.)  
[www.optexamerica.com](http://www.optexamerica.com)

OPTEX (EUROPE) LTD./EMEA HQ (U.K.)  
[www.optex-europe.com](http://www.optex-europe.com)

OPTEX TECHNOLOGIES B.V./  
OPTEX SECURITY B.V. (The Netherlands)  
[www.optex-europe.com/nl](http://www.optex-europe.com/nl)

OPTEX CO., LTD. (JAPAN)  
[www.optex.net](http://www.optex.net)

OPTEX SECURITY SAS (France)  
[www.optex-europe.com/fr](http://www.optex-europe.com/fr)

OPTEX SECURITY Sp.z o.o. (Poland)  
[www.optex-europe.com/pl](http://www.optex-europe.com/pl)

OPTEX PINNACLE INDIA,  
PVT., LTD. (India)  
[www.optexpinnacle.com](http://www.optexpinnacle.com)

OPTEX KOREA CO.,LTD. (Korea)  
[www.optexkorea.com](http://www.optexkorea.com)

OPTEX (DONGGUAN) CO.,LTD.  
SHANGHAI OFFICE (China)  
[www.optexchina.com](http://www.optexchina.com)

OPTEX (THAILAND) CO., LTD. (Thailand)  
[www.optex-asean.com](http://www.optex-asean.com)

Copyright (C) 2025 OPTEX CO.,LTD.

## 4 RLS-LBL Installation

Use RLS-LBL when:

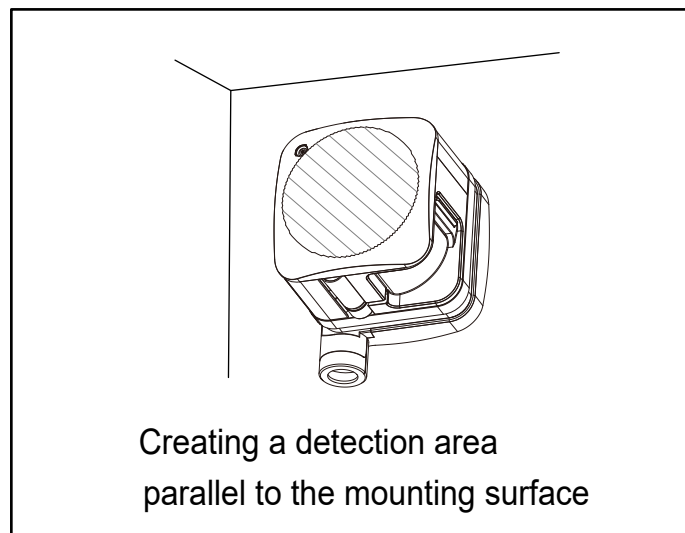
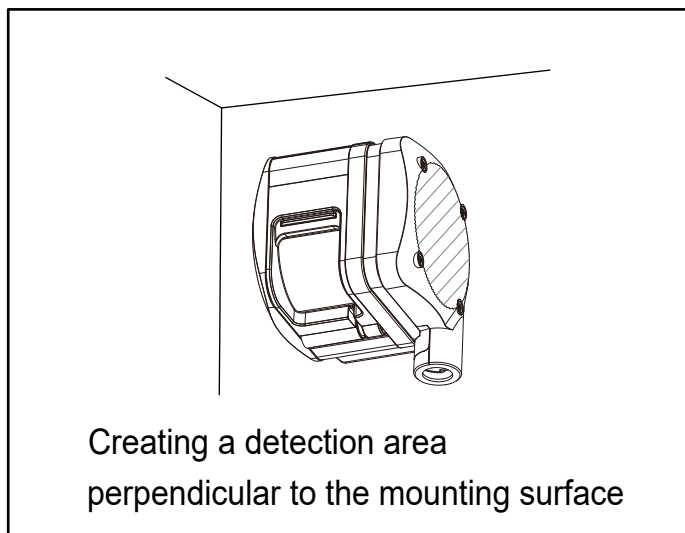

Go to

4-1 Perpendicular Detection Arrangement

Go to

4-2 Parallel Detection Arrangement

### 4-1 Perpendicular Detection Arrangement

1 Remove top cover.

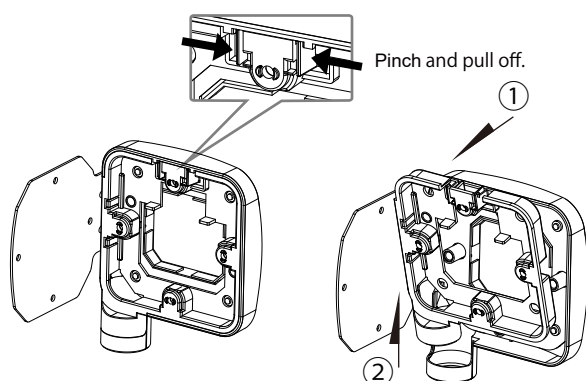

2 Fix bracket to wall or ceiling.

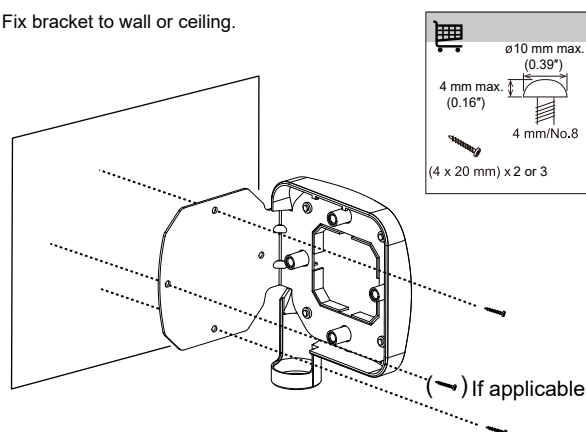

3 Insert cables.

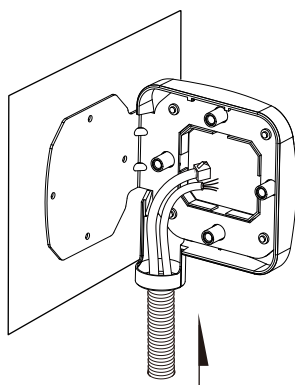

4 Set in top cover.

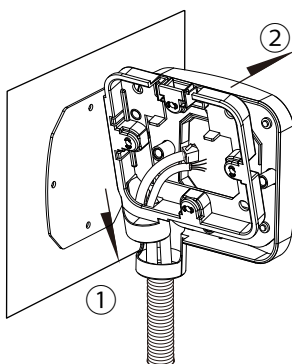

5 Fix mounting plate of RLS-1010L to the bracket.

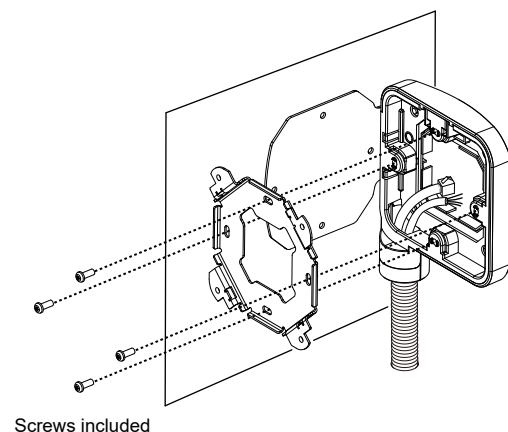

Go to

5 REDSCAN Lite Installation on RLS-LBL

## 4-2 Parallel Detection Arrangement

**1** Remove top cover.

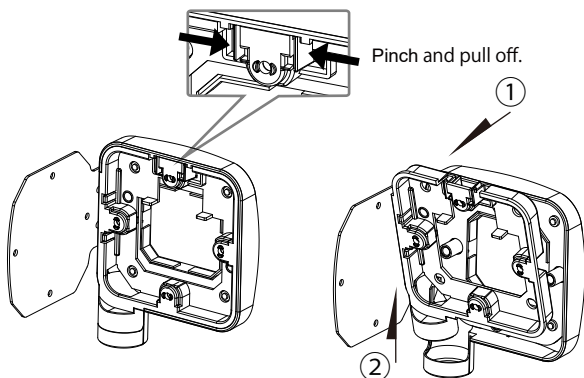

**2** Modify slit cover.

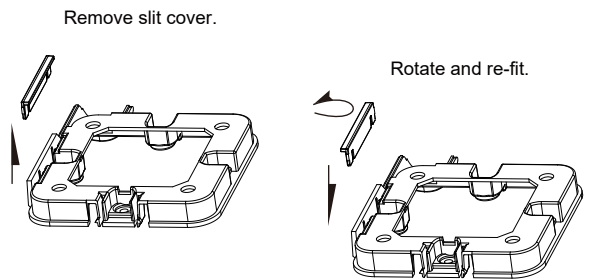

**3** Unscrew

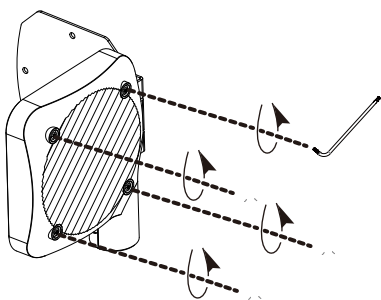

**4** Remove L shape Mounting Plate

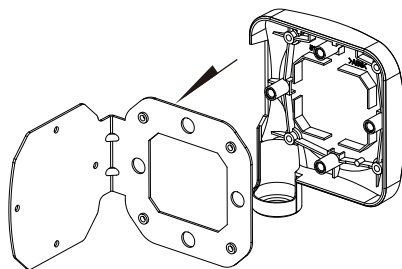

**5** Fix bracket to wall or ceiling.

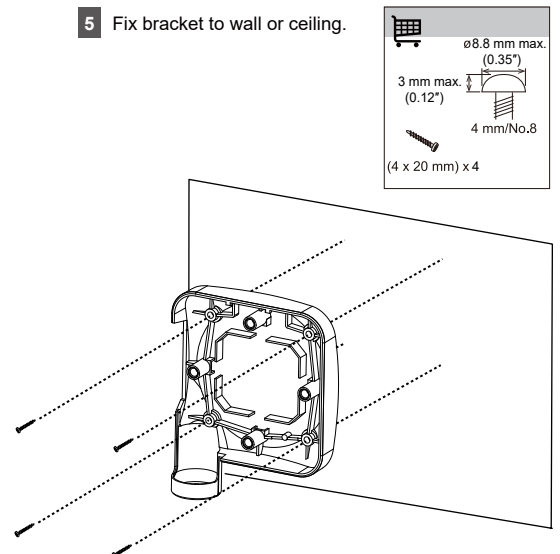

**6** Insert cables.

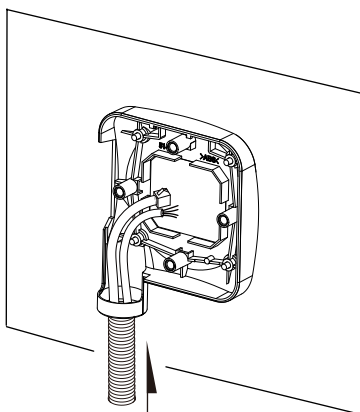

**7** Set in top cover.

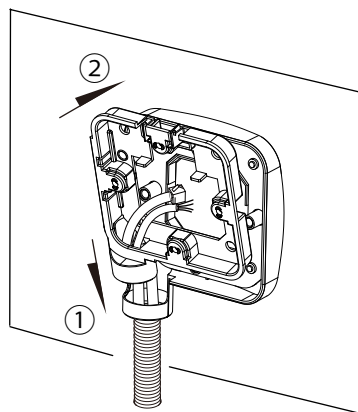

**8** Fix mounting plate of RLS-1010L to the bracket.

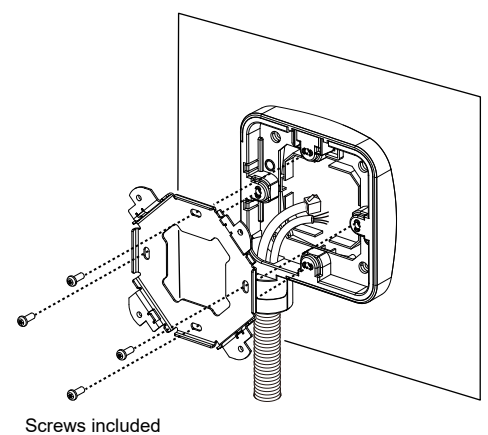

Go to

**5** REDSCAN Lite Installation on RLS-LBL

## 5 REDSCAN Lite Installation on RLS-LBL

1 Before wiring, optimize each cable length.

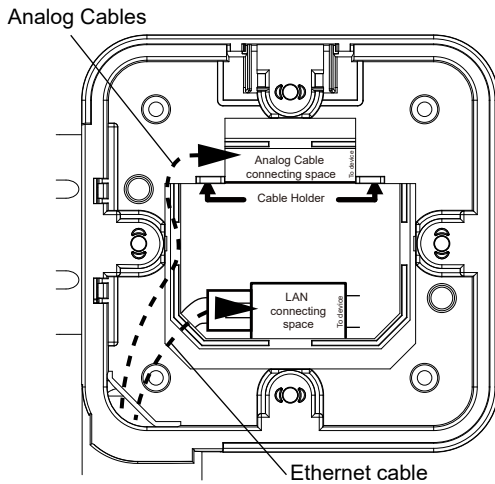

2 Use the nylon string to hang the main unit while connecting wires.

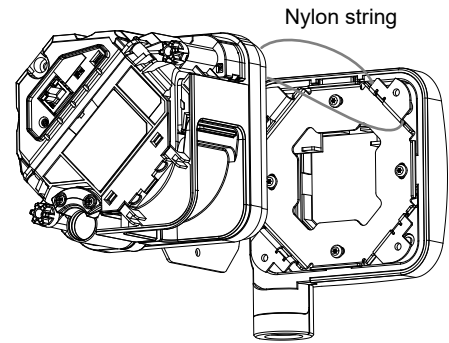

3 Prepare connection.

Push lever to snap in or to release wire.

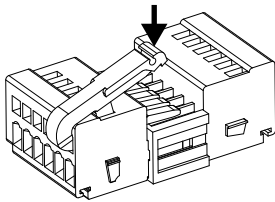

Connector for signals

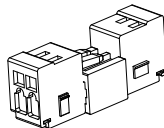

Connector for power  
Need for DC power connection

Strip the sheath from the wire to be used.

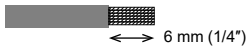

! - Mind sharp edge in the tight space.

4 Place connectors at the marked location and make space to store the cables.

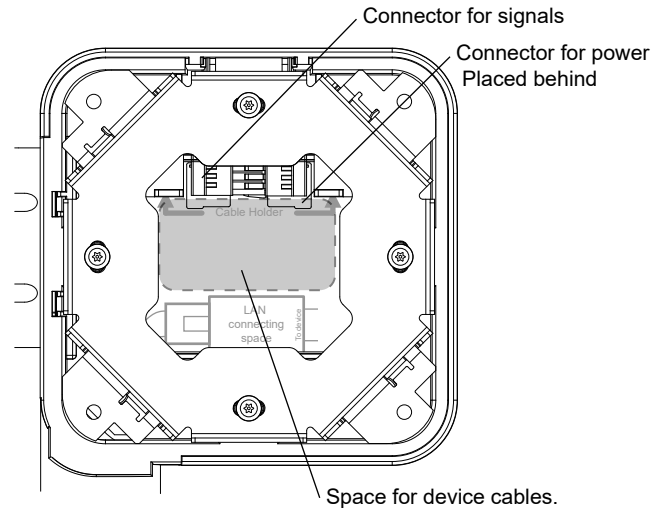

The subsequent steps are common regardless of the installation method.  
Refer to the "Important Information" document of the RLS-1010L unit.

Go to

RLS-1010L 2 Mounting

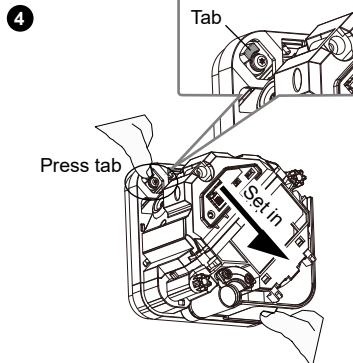
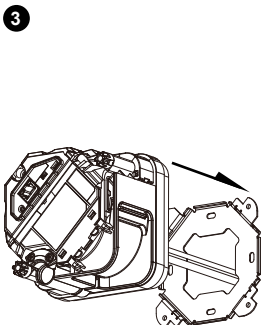

! Slide and secure while pressing down at the two points as shown in the above figure. Be careful not to pinch the wires.

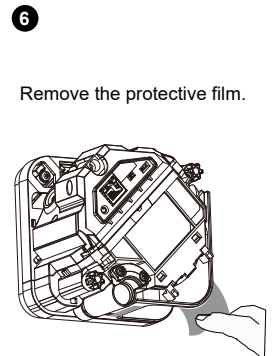
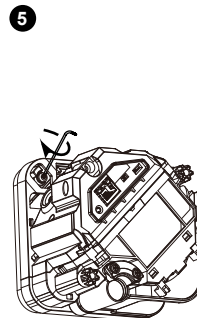

Remove the protective film.